

triangle  
plaza



Brian Grabowski  
919-674-2000  
brian@retail-rep.com

Capital Boulevard and Old Wake Forest Road, Raleigh, NC  
Just Inside I-540. Across from Triangle Town Center

Population-	3 mile: 77,983	5 mile: 169,786
Median Income-	3 mile: \$57,684	5 mile: \$61,689
2009 Traffic Count	South: 45,000	North: 55,000
	I-540: 58,000	



**WIN PROPERTIES INC.**

10 Rye Ridge Plaza  
 Suite 200  
 Rye Brook, NY 10573  
 Tel: (914) 468-7300  
 Fax: (914) 468-7330

**PLANTATION POINT SHOPPING CENTER**  
 BJS WHOLESALE CLUB  
 MARSHALL'S  
 PETCO

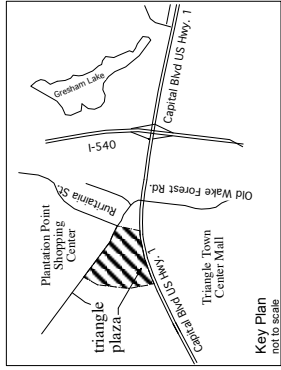

**Architectural Group PA**  
 ARCHITECTURE - PLANNING - INTERIOR ARCHITECTURE  
 2321 Blue Ridge Road, Suite 201, Raleigh, North Carolina 27607  
 919 860 0229 Fax 919 785 0199 [www.aggpa.com](http://www.aggpa.com)

**SITE DATA**

BEST BUY S.F.	45,000
MARKET S.F.	17,700
SHOPS S.F.	2,674
TOTAL GLA	89,149
SPRINKLER RM.	227
TEENANT REQUIRED PARKING	
25 x 4 =	100
64 x 5 =	320
TOTAL =	420

PARKING SHOWN  
 TOTAL = 499 SPACES

**TRIANGLE TOWN CENTER MALL**  
 DILLARD'S  
 MACYS  
 SAKS FIFTH AVENUE  
 SEARS  
 HUDSON BELK

**triangle plaza**  
 6101 Capital Blvd.  
 Raleigh, NC

L-1

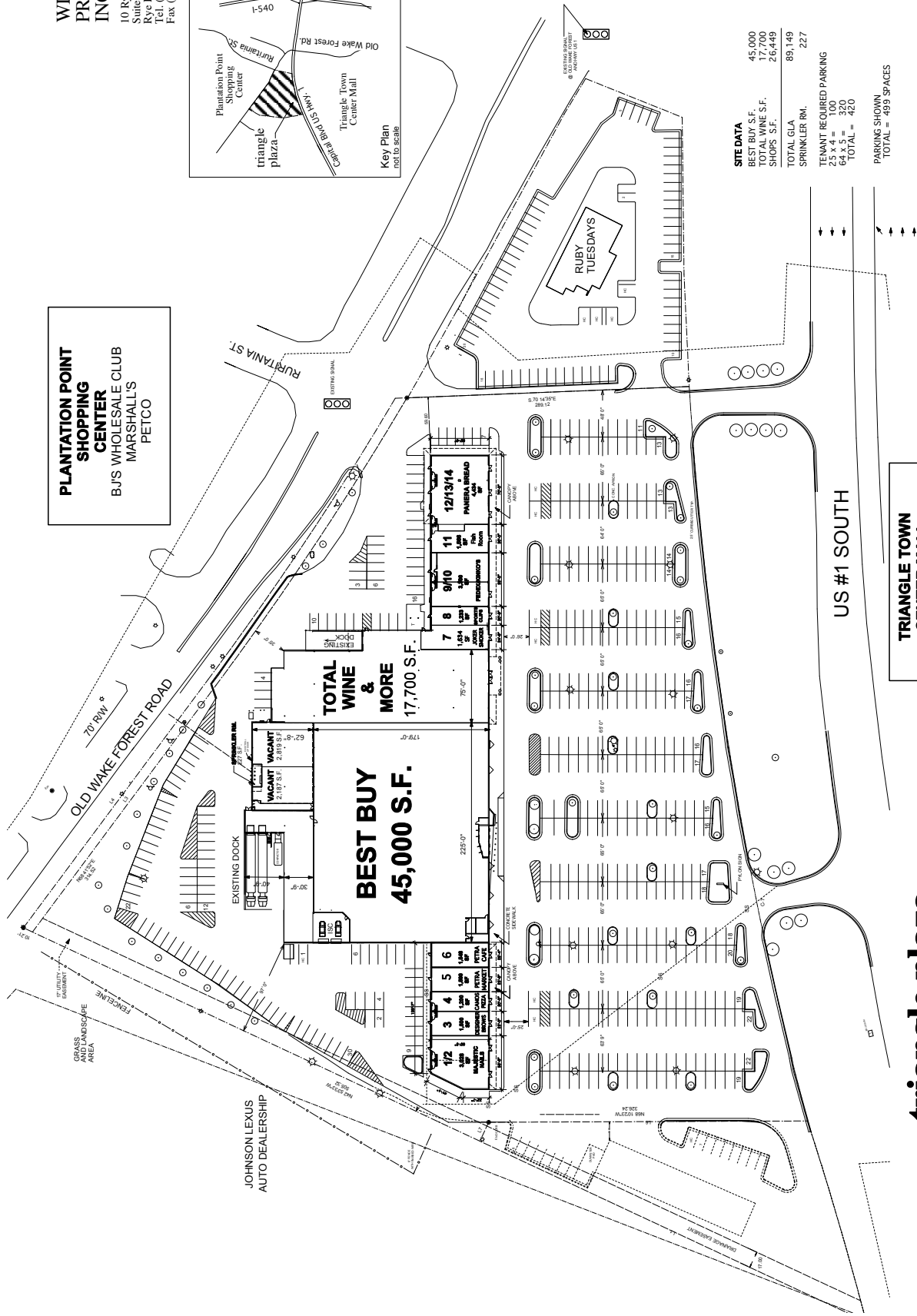

US #1 SOUTH

70' R/W

OLD WAKE FOREST ROAD

RURITANIA ST.

TOTAL WINE & MORE  
 17,700 S.F.

BEST BUY  
 45,000 S.F.

RUBY TUESDAYS

US #1 SOUTH

**TRIANGLE TOWN CENTER MALL**  
 DILLARD'S  
 MACYS  
 SAKS FIFTH AVENUE  
 SEARS  
 HUDSON BELK

**triangle plaza**  
 6101 Capital Blvd.  
 Raleigh, NC

L-1

# 2009 ADT

